

LB-106783

ITEM	DESCRIPTION	PART NO.	QTY
	KIT CATALOG NO.	59M03	
	UNIT MODEL NO.	G26/90UGF/G32	
	S.A. CONTROL NO.	LB-106783A	
1	PIPE (VENT)	100653-01	1
2	ADAPTER (EXHAUST)	100667-01	1
3	COUPLING (PLASTIC)	73K8401	1
4	FITTING (ELL)	79J9001	2
5	BOOT (FLUE TRAP)	100666-01	1
6	CLAMP-.375" (DRAIN)	56M8901	1
7	CARTON	88A7601	1
8	TUBE (VINYL)	LB-106785B	1
9	TUBE (VINYL)	LB-106785A	1
10	TUBE (VINYL)	LB-106785C	1
11	PLUG	46F4801	1
12	KRAFT PAPER	299006002	A/R
13	TAPE (25" PER SIDE)	299011022	50"
14	INSTALL. INSTRUCTIONS	504760M	1

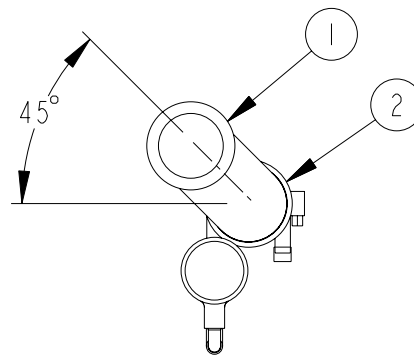

TOP VIEW  
(ORIENTATION OF ITEMS #1 & #2)

ASSEMBLE ITEMS BEFORE PLACING INTO ITEM #7.

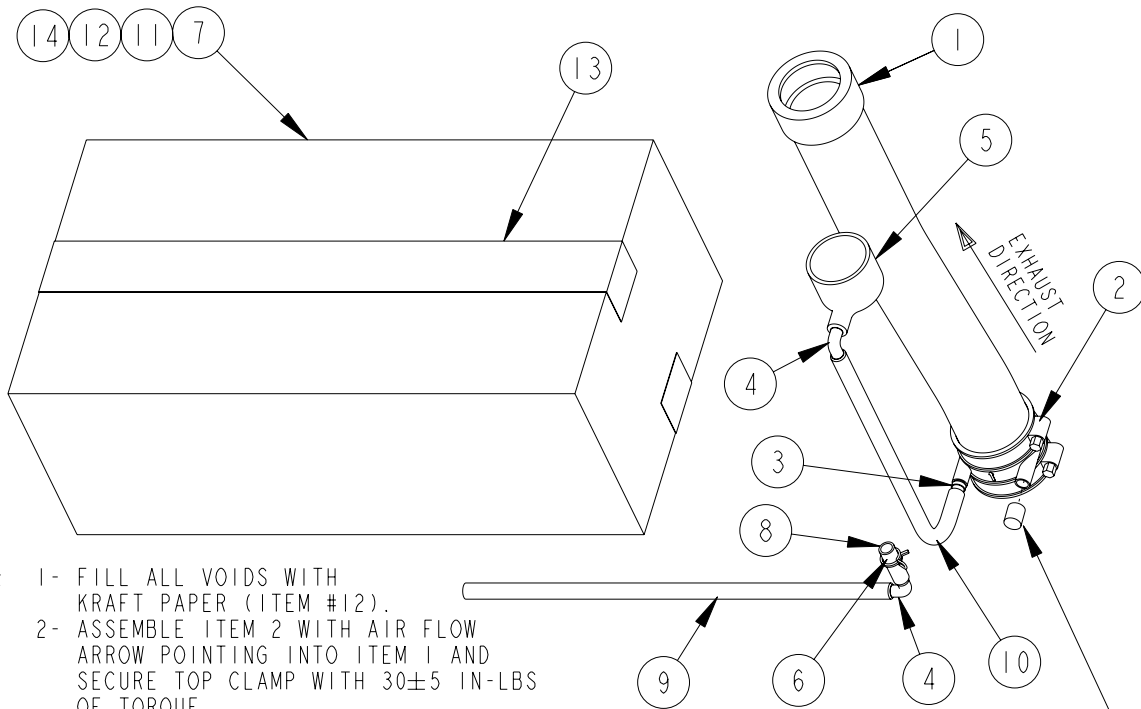

NOTE: 1- FILL ALL VOIDS WITH KRAFT PAPER (ITEM #12).  
2- ASSEMBLE ITEM 2 WITH AIR FLOW ARROW POINTING INTO ITEM 1 AND SECURE TOP CLAMP WITH 30±5 IN-LBS OF TORQUE.

YELLOW CAP PROVIDED WITH ITEM #2

NO.	GROUP	OPERATIONS

ALT. NO.	DATE	ALTERATIONS	INITIAL USAGE
1	2-25-03	INITIAL ECN RELEASE : E701716 DRN BY : DAO	
1	3-10-03	ECN - E701757: (DAO) A) MOVED ITEMS 3, 4, 5 & 10 IN ISO VIEW TO LEFT OUTLET. B) ADDED ITEM #11 TO ISO VIEW & ADDED TOP VIEW.	
2	6-8-05	ECN-E702925: (PSS) A- ITEM 1, 100653-01 WAS 56M8601, ITEM 2, 100667-01 WAS 56M8701 & ITEM 5, 100666-01 WAS 56M8801.	
3	2-7-06	ECN-E703415: (PSS) A- ADDED ARROW FOR EXHAUST DIRECTION AND NOTE 2.	

MANUFACTURING TOLERANCES			
UNLESS OTHERWISE NOTED, ALL FRACTIONAL DIMENSIONS ± 1/32". ALL DECIMAL DIMENSIONS ± 0.030, ALL HOLE DIAMETERS ± 0.005, AND ALL BEND ANGLES ± 2°			
<b>LENNOX</b> Industries Inc.		RESEARCH LABORATORY CARROLLTON, TEXAS	
DESIGN OF KIT - TRANSITION REPLACEMENT			
MAT'L _____			
FOR FINISH SPECS REFER TO ES-0049			
PAIN'T INSIDE	NONE	SHEET NO.	DWG. NO. LB-106783
PAIN'T OUTSIDE	NONE	1 of 1	